

ENOZOPRO SPRAY BOTTLE USER MANUAL SB-100-CA1



RoHS



EnozO₃

CE



EC Declaration of Conformity

1 August, 2017

We declare, under our own responsibility, that the following product, SB-100, which is covered by this declaration of conformity, complies with the **EC Low Voltage Directive 73/23/EEC** and with the **EMC Directive 2004/108/EC**, and is in conformity with the following harmonized standard: **EN 60335-1:2012** and **EN 55014:2012**.

The CE marking is affixed to the device according to the EC directives.

Carl D. Lutz

Carl D. Lutz
Director of Manufacturing

CE

This document reflects the technical status at the time of the revision.
We reserve the right to make changes.

ENGLISH

CONTENTS

- 1 Safety3**
 - 1.1 Symbols from the User Manual..... 3
 - 1.2 Proper Use 3
 - 1.3 Caution 3
 - 1.4 Important Instructions.....4

- 2 Technical Data4**

- 3 Description.....5**
 - 3.1 Description 5
 - 3.2 Key Components 5
 - 3.3 Operating Instructions..... 6

- 4 Preventive Maintenance/Cleaning8**

- 5 Troubleshooting.....8**
 - 5.1 Indicator Lights on Top of Bottle 8
 - 5.2 Battery Replacement..... 8

- 6 Decommissioning (Storage/Disposal).....9**
 - 6.1 Storage 9
 - 6.2 Disposal..... 9

- 7 Service 10**
 - 7.1 Service and Warranty 10
 - 7.2 Service Network -U.S. & Canada 10



IMPORTANT!

Before initial use, the instructions on operating safety, use and maintenance must be read carefully and understood. Keep the user manual in the vicinity of the appliance for later reference.

1.1 SYMBOLS FROM THE USER MANUAL



CAUTION

CAUTION indicates a potentially hazardous situation which, if not avoided, may result in minor or moderate injury.



NOTICE

NOTICE indicates a situation which, if not avoided, may result in damage to the appliance.



Important information can be found here.

1.2 PROPER USE

The EnozoPRO Spray Bottle is intended for commercial and industrial use. It is designed for safe operation when used as directed. The following general safety precautions provide guidance for safe use. Failure to comply with the safety precautions or warnings indicated in this manual violates the safety standards of this equipment. The manufacturer assumes no liability for the user's failure to comply with these requirements.



- Read manual before use.
- It may only be used for its intended purpose.
- Product is intended for residential, industrial and commercial use.
- Do not remove warning labels from unit.
- Fill with clean, potable water only.
- Do not immerse unit in water. Clean exterior of unit with soft cloth. Do not use harsh or abrasive cleaners.
- Do not add any cleaning chemicals into the water reservoir.

1.3 CAUTION



Do not spray toward eyes. In case of eye exposure rinse affected eye(s) thoroughly with clean water for 5 to 10 minutes. If irritation persists, seek medical attention.

- Use only properly ventilated area in conformance to all local and national regulations.
- If overly strong odor of ozone is detected discontinue use.
- If respiratory irritation is experienced discontinue use immediately.
- Do not expose plastic sprayer to extreme heat or open flame.
- Keep out of the reach of children.
- Do not drop sprayer.

1.4 IMPORTANT INSTRUCTIONS

NOTICE



To avoid appliance damage:

Do not drop the bottle.

- Dropping the bottle may cause breakage.

Fill with clean potable water only.

- Filling the bottle with fluids other than clean potable water may damage cartridge and render the product useless.

Do not overfill the bottle.

- Overfilling may cause leakage at the fill plug.

Do not run water into the charger port.

- Doing so may short the battery/electronics .
-

2 TECHNICAL DATA

SPECIFICATIONS SB-100	
Materials	PC/ABS Impact Resistant Plastic
Weight (empty)	~ 2lb (0.9 kg)
Dimensions in (mm)	4 in x 4 in x 11 in (100 mm x 100 mm x 280 mm)
Reservoir Capacity	14 oz (400 ml)
Water Temperature	40 °F to 86 °F (4 °C to 30 °C)
Water Quality	Hardness ≤ 250 ppm CaCO ₃ (May Extend Life of Unit) Conductivity >50 µS/cm (Do not use distilled or deionized water)
Ambient Air	40 °F to 104 °F (4 °C to 40 °C)
Rechargeable Battery	7.4 V Li-Ion (Charger uses 100 V AC to 240 V AC, 50/60 Hz)
Useful Battery life	5000 Reservoir Fills or 500 Charges (Typical)
Model Number	SB-100-CA1
Certifications	CE, TUV, RoHS, WEEE
EPA Establishment Number	089373-MA-001

3 DESCRIPTION

3.1 DESCRIPTION

The EnozoPRO Spray Bottle offers a water-based alternative to traditional cleaners and sanitizers. It turns potable water into aqueous ozone, a food contact sanitizer that kills many common pathogens found on hard, non-porous surfaces and destroys organic odors.

The tiny electrolytic cell is created from a proprietary diamond process technology and generates ozone on-demand from water itself. Water exists in the reservoir and the ozone is activated on-demand, creating the sanitizer. This eliminates inventory of many chemicals and the constant need to repurchase supplies. Furthermore, it leaves no residue.

3.2 KEY COMPONENTS

1. Indicator LEDs
2. Charging Port
3. Spray Nozzle
4. Diamond Cell
5. Spray Trigger
6. Fill Plug
7. Water Reservoir
8. Battery and Control Electronics

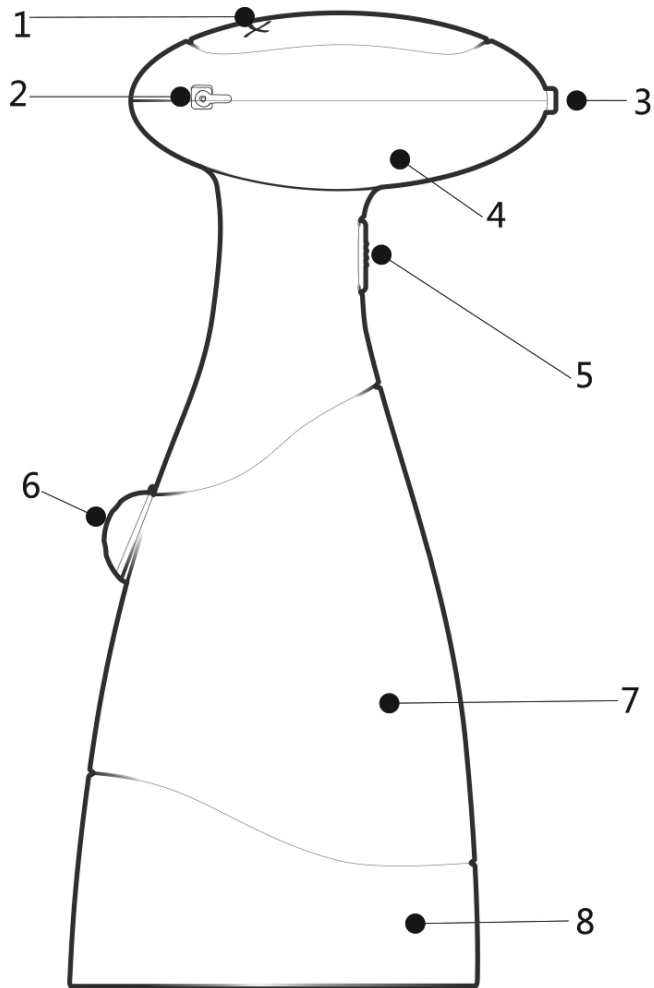

NOTE: Product may vary from illustrations

Water Based Food Contact Sanitizer

- Proven sanitizer
- Reduces common pathogens
- Destroys odor-causing microorganisms
- Ensures efficacy and compliance to regulations

Dependable, On-Demand Solution

- Ozone (O₃) is activated as-needed
- Runs on long lasting rechargeable batteries
- Requires only clean, potable water
- User-friendly lights indicate when sanitizer is active

Alternative

- Leaves behind no residues
- Compatible with all surfaces where water may be used
- Eliminates potential errors with mixing or diluting
- Ingredients by weight:
 - 99.9998% Water
 - 0.0002% Ozone
 - No fragrance added

3.3 OPERATING INSTRUCTIONS

IMPORTANT: Please read these instructions completely before use.

Use this product to clean hard, non-porous, nonfood contact surfaces.

- Tables and countertops
- Kitchen surfaces
- Bathroom surfaces
- Doors and handles
- Pet accident odors
- Windows

Charge the Unit

Before using the sprayer for the first time, charge the batteries. The first charge may take up to 3 hours. The red light on the charger indicates that the device is being charged. The charge is complete when the light on the charger is green. Note: The spray bottle will not operate while connected to the battery charger.

Connect the battery charger to a 100-240 V AC 50/60 Hz power source. Connect the battery charger power cord to the spray bottle. The system is powered by a 7.4 V Li-Ion rechargeable battery pack. A 100 to 240 V AC 50/60 Hz charger is included. Use only the charger provided.

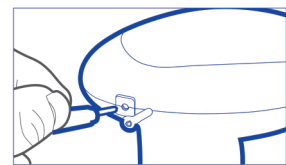

Charge plug location

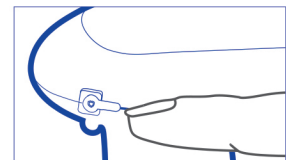

After Charging, it is important to securely push protective flap back in place.

Fill the Reservoir

Remove the fill cap to fill the reservoir with 14 oz of clean, cold potable water. While holding the unit in the horizontal position, fill reservoir about half full. Securely replace the fill plug. Turn bottle in vertical position and check fill line. Repeat until water reaches fill line. Do not overfill. Do not fill with hot water.



CAUTION

FILL WITH CLEAN, COLD POTABLE WATER ONLY. DO NOT OVERFILL THE BOTTLE. DO NOT RUN WATER INTO THE CHARGER PORT. WATER TEMPERATURE 40 °F to 86 °F (4 °C to 30 °C)

Prime the Spray Bottle

When new, or after long storage, the ozone generator cell in the bottle may become de-primed and dry. In this condition the blue light will not illuminate while spraying and the red and blue lights will flash twice when the trigger is released.

To prime the spray bottle, continue to spray with the blue light off until the blue light turns on and remains on. If the blue light does not illuminate after 2 minutes of spraying, adding ordinary table salt to the tank will help prime the ozone cell. Fill the tank with fresh tap water. Add and mix one teaspoon (5 grams) of salt into the tank. Spray out the entire tank of water into a sink. Fill the tank with fresh tap water and spray 30 seconds. Your bottle is now ready to use. The salt procedure may have to be repeated if the bottle sits unused for an extended period.

Sanitize Food Contact Surfaces

Hold the spray bottle 15 to 20cm from the surface and spray evenly until wet. For 99.9% effectiveness against common pathogens allow to stand for 30 seconds. Wipe with a clean cotton or microfiber cloth or allow to air dry. No rinsing is necessary (leaves no residue). Ozone is generated on demand. While spraying, the blue indicator will light when the unit is operating properly. When sanitizing surfaces use the included Ozone Test Kit to insure a concentration of 0.5ppm or greater to assure effective sanitation.

General Purpose Cleaning

When generally cleaning surfaces use the included OzoneTest Kit to insure production of 0.2ppm or greater to assure effective cleaning.

Glass Cleaning

When cleaning glass surfaces use the included Ozone Test Kit to insure production of 0.2ppm or greater to assure effective removal of streaks and smears.

Improper use of this product may affect cleaning performance

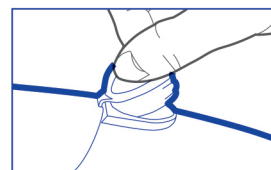

Remove cap.

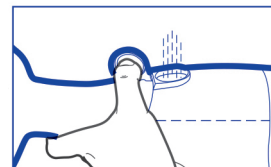

Fill approximately half full in horizontal position.

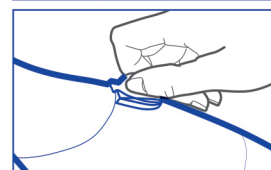

Secure fill plug.

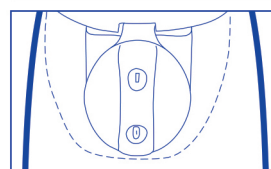

Sit bottle on counter and check water level with fill line.

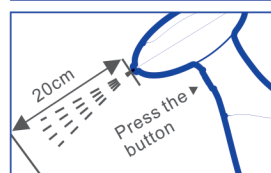

Hold 15-20cm away from surface.

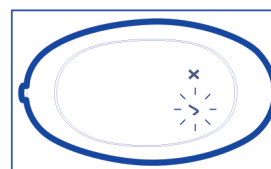

While spraying, blue light indicates unit is working properly.

4 PREVENTIVE MAINTENANCE/CLEANING

1. Charge unit nightly to ensure full capacity the next day.
2. Clean bottle with moistened cloth only. Do not use chemicals or cleaners.

5 TROUBLESHOOTING

5.1 INDICATOR LIGHTS ON TOP OF BOTTLE

LIGHTED INDICATORS	SYSTEM MESSAGE
SOLID BLUE	System is operating properly
ONE RED FLASH	Battery is low
TWO RED FLASHES	Reservoir is empty
THREE RED FLASHES	Battery needs recharging
TWO RED AND BLUE FLASHES	System fault; recharge and try again. If error persists, contact service department.
ALL OTHER PROBLEMS	Contact service department

5.2 BATTERY REPLACEMENT

The battery can be replaced. Detailed instructions are included with the replacement battery kit.

A replacement battery can be ordered through your dealer where you purchased this product, or through the Service Department as listed in chapter 7 of this manual.

6 DECOMMISSIONING (STORAGE/DISPOSAL)

6.1 STORAGE

Empty tank through the fill plug. Do not spray empty. Leave fill plug open to allow tank to dry.

6.2 DISPOSAL



Disassembly of the appliance must be performed by qualified specialists according to the manufacturer's instructions.

- Follow the local safety regulations.
- Dispose of the appliance in accordance with local regulations.
- It is essential that you observe the laws and regulations for the disposal of environmentally harmful substances. Obtain detailed information about their disposal – such substances include plastics and decommissioned battery packs and Li-Ion battery.

Special regulations apply when disposing of used electrical appliances:

The customer assumes responsibility for proper disposal of the delivered product after the end of its service life at the customer's own expense, in accordance with legal regulations.

7 SERVICE

7.1 Service and Warranty

The manufacturer warrants new equipment to be free of defects due to poor materials or workmanship for the period of time listed below (following the date of original installation):

- One year replacement

Exclusions: Certain Enozo parts that are expendable by nature and that need to be replaced frequently may not be covered. Enozo is not liable under these warranties for repairs or damages due to improper operation, attempted repairs or installation by unauthorized persons, alterations, abuse, fire, flood, or acts of nature.

Additionally, this warranty may be voided in the case of:

- Failure to follow instructions for use, care or maintenance
- Removal, alteration or defacing of the serial number and other labels
- Service by a non-authorized service company
- Mechanical damage
- Use with any other fluids other than clean, potable water

This warranty is conditional upon receiving notice of any defect subject to this warranty within thirty (30) days of its original discovery by the Buyer.

For service or warranty questions, contact customer service.

7.2 Service Network - U.S. & Canada

Enozo Technologies, Inc.

Customer Service: 1-978-233-4847

support@enozo.com





S3083 Revision date: 04.13.2020

